



Oceanic

Aluminium Industries

Strength in Aluminium, Trust in Quality



Manufacturers of : All Kinds of Aluminium Profiles



Oceanic Solvent Industries Compound, Bedeshwar,
JAMNAGAR - 361 002. (Gujarat) INDIA.



+91 99137 67167, +91 98251 32164, +91 81283 10066



oceanicaluind@gmail.com, info@oceanicaluminiumindustries.com



www.oceanicaluminiumindustries.com



Oceanic
Aluminium Industries

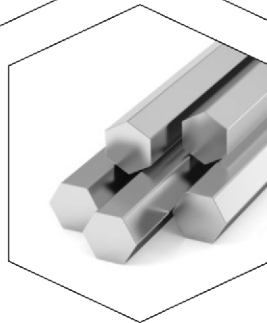
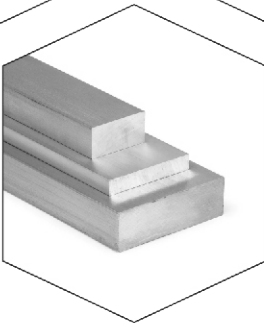
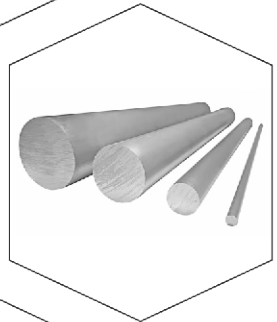
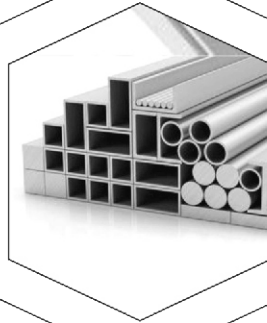
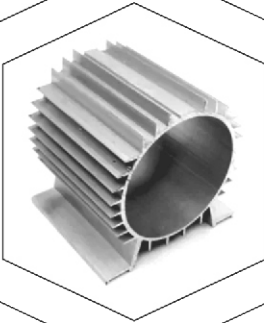
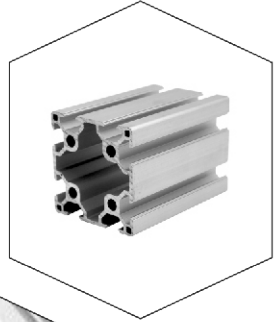



Welcome to Oceanic Aluminium Industries !

Discover excellence in aluminum solutions tailored for your needs. Located in Jamnagar, Oceanic Aluminium Industries is your trusted partner for premium aluminium profiles.

We serve diverse industries

- Commercial : Providing tailored aluminium solutions for commercial projects.
- Architectural and Design Firms : Collaborating with the architectural community for innovative designs.
- Electrical and Rheomaterial Industries : Offering customized profiles to meet specific industry needs.
- Automotive : Crafting aluminium parts for motor bodies and auto components.
- Defense and Aerospace: Supplying high-quality aluminium parts for defense and aerospace applications.

Commitment to Quality

At Oceanic Aluminium Industries, quality is paramount. Our profiles undergo rigorous checks to ensure they meet the highest standards of durability, performance, and precision.

Specifications

- Press : **1450 MT** Hydraulic Press with **165 mm** Bore size.
- Dies : **220 mm, 240 mm & 260 mm**
- Maximum Diagonal Design size **170 mm**

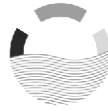

H-A

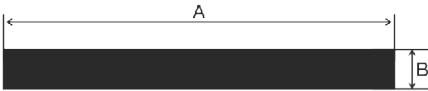

Sr.	A	B	Weight (KG/12FT)
1.	15	8	1.19
2.	25	4	0.99
3.	25	6	1.48
4.	25	8	1.98
5.	30	10	2.96
6.	30	3	0.90
7.	30	8	2.37
8.	32	12	3.79
9.	29	15	4.30
10.	40	10	3.95
11.	20	10	2.03
12.	25	12	2.98
13.	50	12	5.92
14.	50	25	12.34
15.	32	25	7.92
16.	50	4	1.98
17.	50	8	3.95
18.	12	5	0.59
19.	12.30	7.30	0.88

H-B

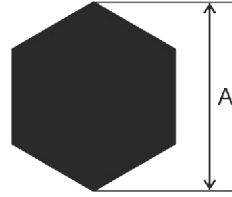

Sr.	A	Weight (KG/12FT)
1.	19	1.19
2.	25	0.99
3.	32	1.48
4.	28.5	1.98

H-C

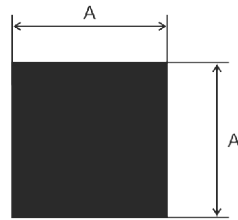

Sr.	A	Weight (KG/12FT)
1.	10	0.99
2.	16	2.49
3.	25	6.17
4.	32	10.12

H-D

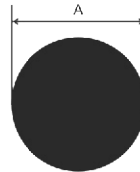

Sr.	A	Weight (KG/12FT)
1.	16	1.98
2.	19	2.83
3.	25	4.85
4.	28	6.1
5.	32	7.95
6.	40	12.41
7.	45	15.71



H-E

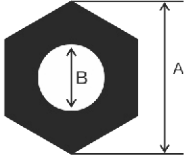

Sr.	A	B	Weight (KG/12FT)
1.	25.00	10.00	4.100
2.	25.00	16.00	3.000
3.	28.00	10.00	5.310
4.	30.00	14.00	5.527

H-F

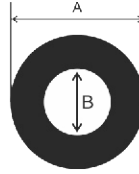

Sr.	A	B	Weight (KG/12FT)
1.	76.00	46.00	28.400
2.	112.00	70.50	58.780
3.	51.00	25.00	15.330
4.	62.00	34.00	20.860
5.	68.00	41.00	22.840
6.	19.00	17.00	00.600
7.	42.00	31.00	06.260

I-1

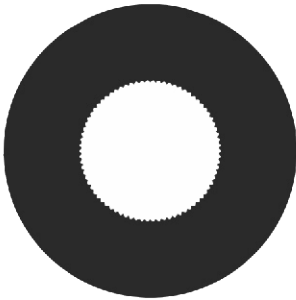

I-2



I-3



I-4

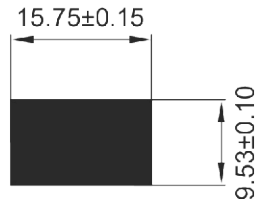

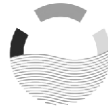

I-5



I-6

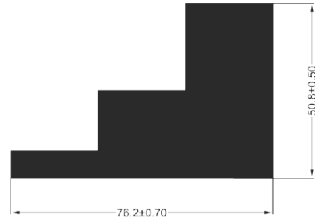

I-7



I-8

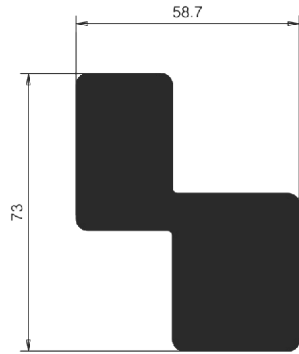

I-9

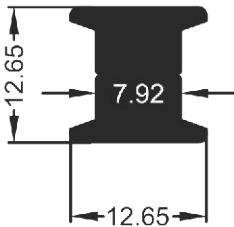

I-10

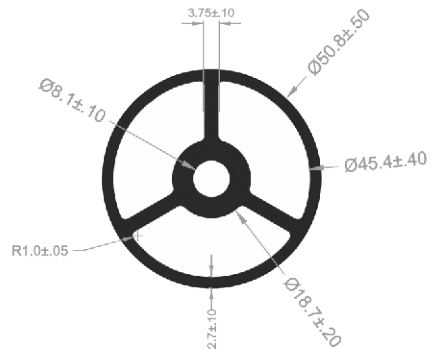



I-11

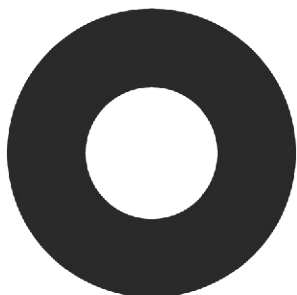

I-12



I-13



I-14

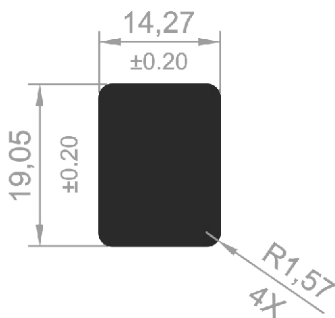

I-15

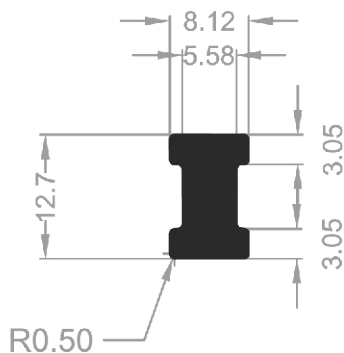

I-16





I-7



I-18

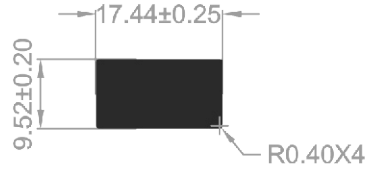

I-19

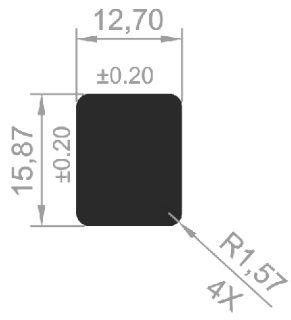

I-20



I-21



I-22





I-23



I-24



I-25



I-26



I-27

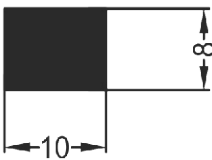

WT-.790Kg

I-28

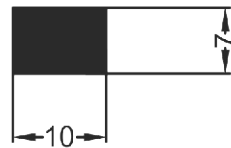

WT-.690Kg



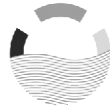

Oceanic
Aluminium Industries



H-1 (Kg. / 12 Ft. = 1.92)

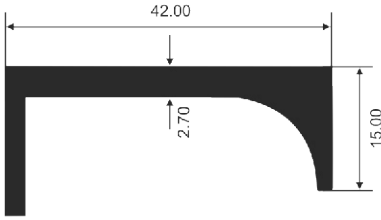

H-2 (Kg. / 12 Ft. = 1.92)

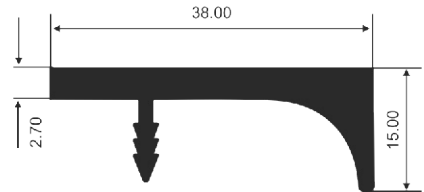

H-3 (Kg. / 12 Ft. = 1.92)



H-4 (Kg. / 12 Ft. = 1.92)

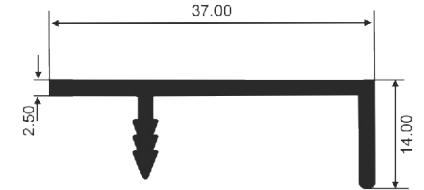

H-5 (Kg. / 12 Ft. = 1.92)

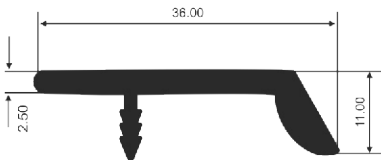

H-6 (Kg. / 12 Ft. = 1.92)

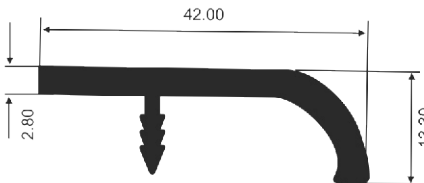

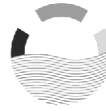

H-7 (Kg. / 12 Ft. = 1.92)

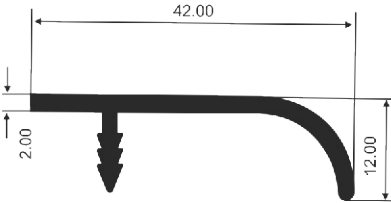

H-8 (Kg. / 12 Ft. = 1.92)

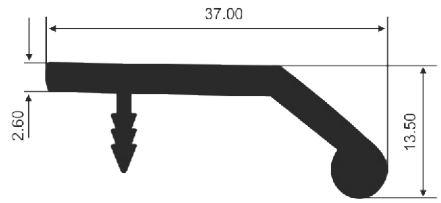

H-9 (Kg. / 12 Ft. = 1.92)

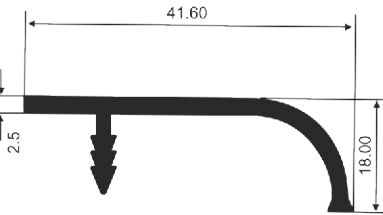

H-10 (Kg. / 12 Ft. = 1.92)

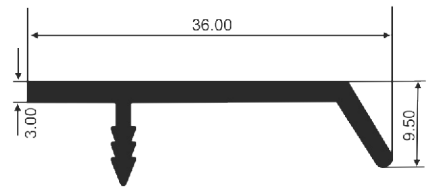

H-11 (Kg. / 12 Ft. = 1.92)

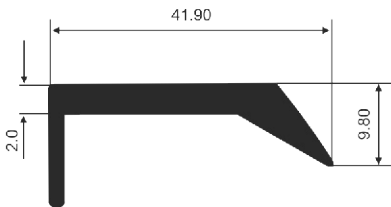

H-12 (Kg. / 12 Ft. = 1.92)

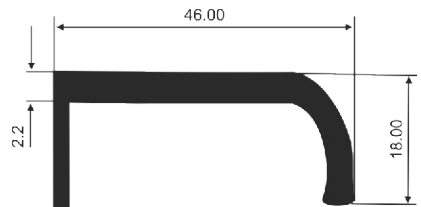



H-13

(Kg. / 12 Ft. = 1.92)

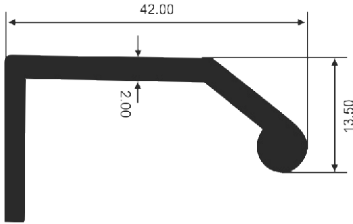

H-14

(Kg. / 12 Ft. = 1.92)

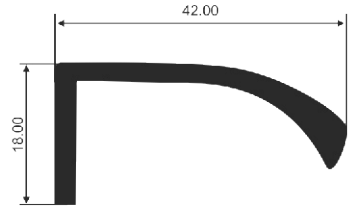

H-15

(Kg. / 12 Ft. = 1.92)

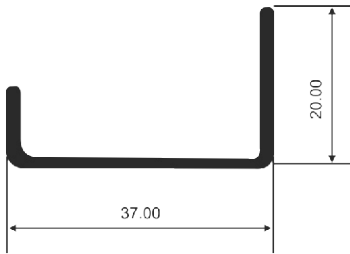

H-16

(Kg. / 12 Ft. = 1.92)



H-17

(Kg. / 12 Ft. = 1.92)

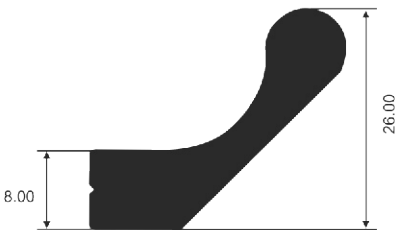

H-18

(Kg. / 12 Ft. = 1.92)

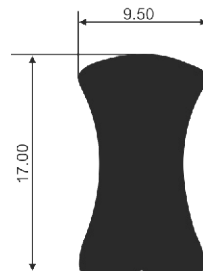

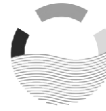

H-19 (Kg. / 12 Ft. = 1.92)

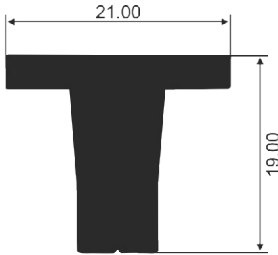

H-20 (Kg. / 12 Ft. = 1.92)

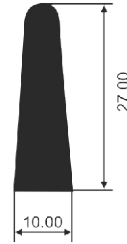

H-21 (Kg. / 12 Ft. = 1.92)

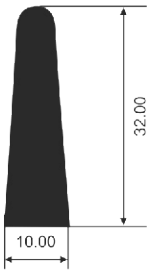

H-22 (Kg. / 12 Ft. = 1.92)

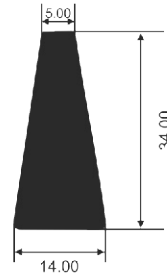

H-23 (Kg. / 12 Ft. = 1.92)

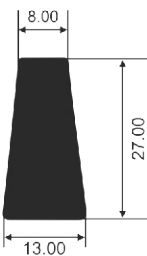

H-24 (Kg. / 12 Ft. = 1.92)





H-25 (Kg. / 12 Ft. = 1.92)

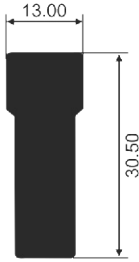

H-26 (Kg. / 12 Ft. = 1.92)

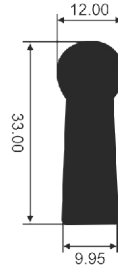

H-27 (Kg. / 12 Ft. = 1.92)

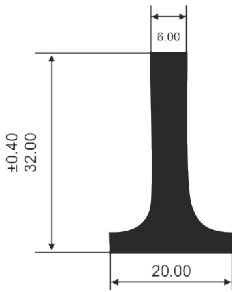

H-28 (Kg. / 12 Ft. = 1.92)

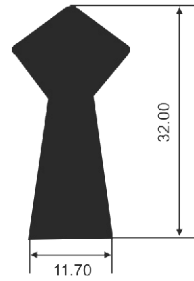

H-29 (Kg. / 12 Ft. = 1.92)

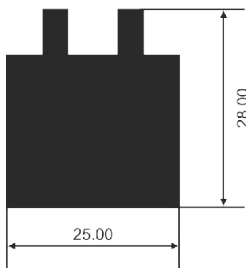

H-30 (Kg. / 12 Ft. = 1.92)

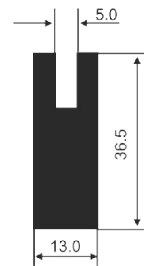

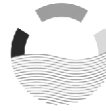

H-31 (Kg. / 12 Ft. = 1.92)

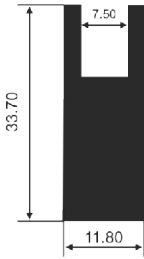

H-32 (Kg. / 12 Ft. = 1.92)

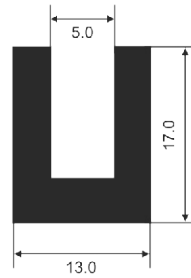

H-33 (Kg. / 12 Ft. = 1.92)

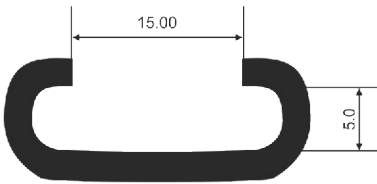

H-34 (Kg. / 12 Ft. = 1.92)

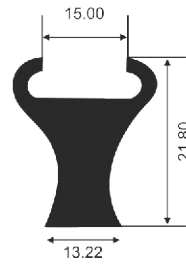

H-35 (Kg. / 12 Ft. = 1.92)

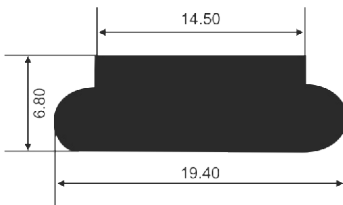

H-36 (Kg. / 12 Ft. = 1.92)

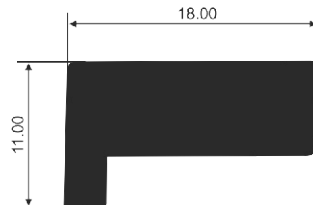



H-37 (Kg. / 12 Ft. = 1.92)

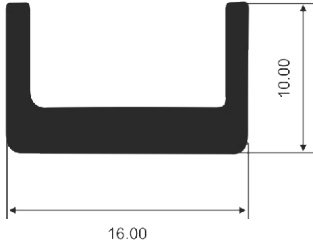

H-38 (Kg. / 12 Ft. = 1.92)

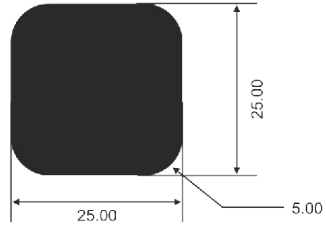

H-39 (Kg. / 12 Ft. = 1.92)

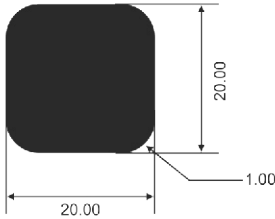

H-40 (Kg. / 12 Ft. = 1.92)

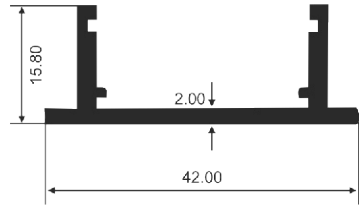

H-41 (Kg. / 12 Ft. = 1.92)

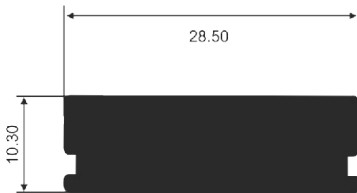

H-42 (Kg. / 12 Ft. = 1.92)

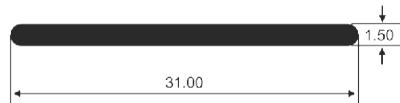

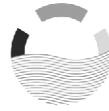

H-43 (Kg. / 12 Ft. = 1.92)

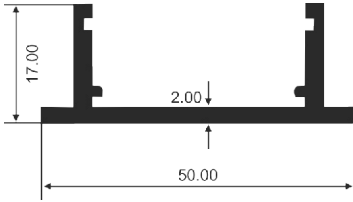

H-44 (Kg. / 12 Ft. = 1.92)



H-45 (Kg. / 12 Ft. = 1.92)

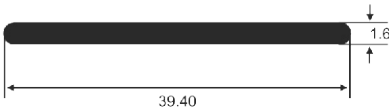

H-46 (Kg. / 12 Ft. = 1.92)

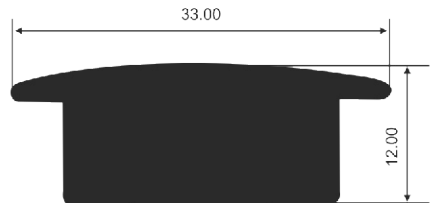

H-47 (Kg. / 12 Ft. = 1.92)

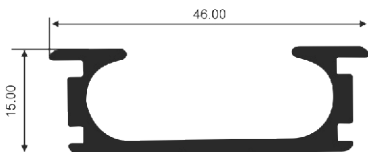

H-48 (Kg. / 12 Ft. = 1.92)

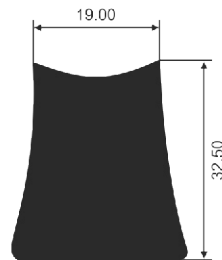



H-49 (Kg. / 12 Ft. = 1.92)

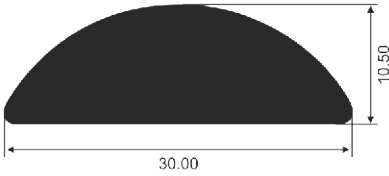

H-50 (Kg. / 12 Ft. = 1.92)

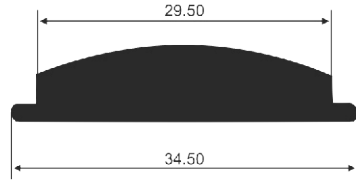

H-51 (Kg. / 12 Ft. = 1.92)

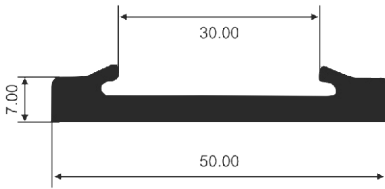

H-52 (Kg. / 12 Ft. = 1.92)

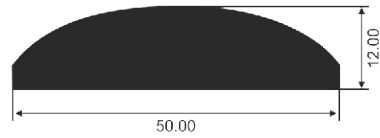

H-53 (Kg. / 12 Ft. = 1.92)

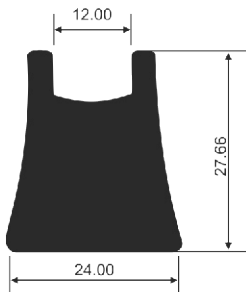

H-54 (Kg. / 12 Ft. = 1.92)

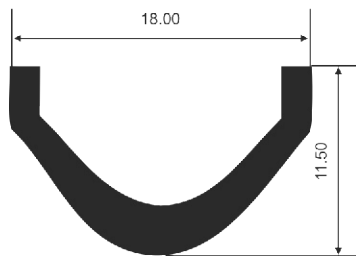



H-55 (Kg. / 12 Ft. = 1.92)

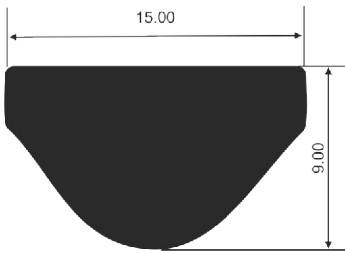

H-56 (Kg. / 12 Ft. = 1.92)

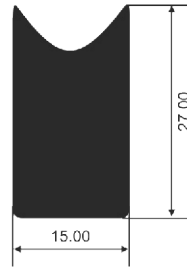

H-57 (Kg. / 12 Ft. = 1.92)

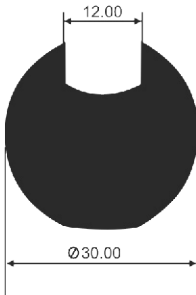

H-58 (Kg. / 12 Ft. = 1.92)

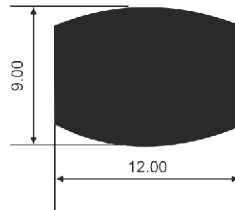

H-59 (Kg. / 12 Ft. = 1.92)

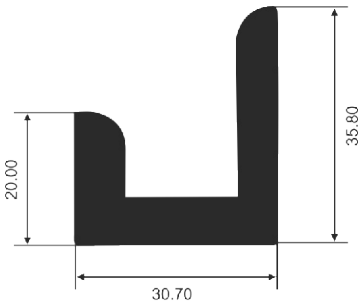

H-60 (Kg. / 12 Ft. = 1.92)

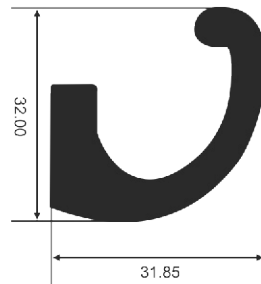



H-61

(Kg. / 12 Ft. = 1.92)

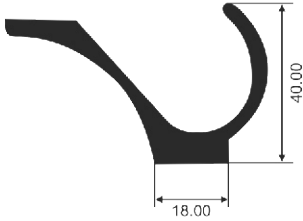

H-62

(Kg. / 12 Ft. = 1.92)

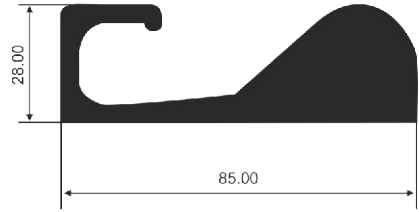

H-63

(Kg. / 12 Ft. = 1.92)

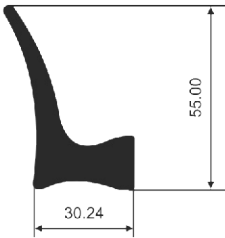

H-64

(Kg. / 12 Ft. = 1.92)

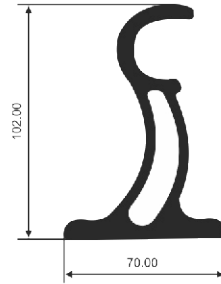

H-65

(Kg. / 12 Ft. = 1.92)

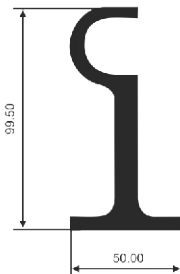

H-66

(Kg. / 12 Ft. = 3.100)

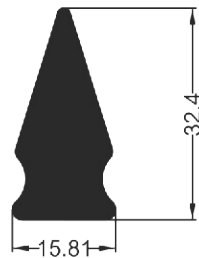

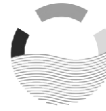

H-67 (Kg. / 12 Ft. = 5.800)

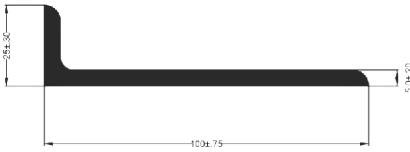

H-68 (Kg. / 12 Ft. = 4.270)

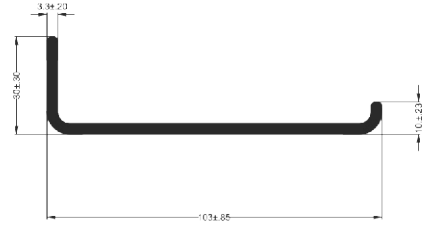

H-69 (Kg. / 12 Ft. = 7.100)

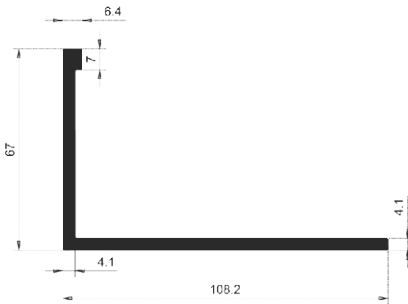

H-70 (Kg. / 12 Ft. = 4.530)

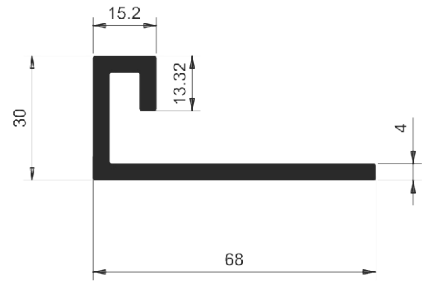



TB-1

(Kg. / 12 Ft. = 1.92)

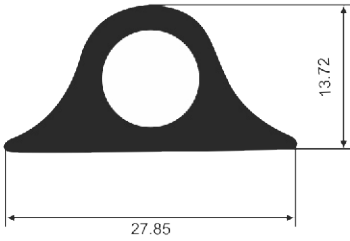

TB-2

(Kg. / 12 Ft. = 1.92)

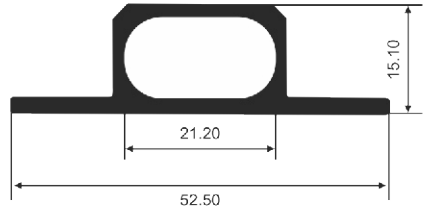

TB-3

(Kg. / 12 Ft. = 1.92)

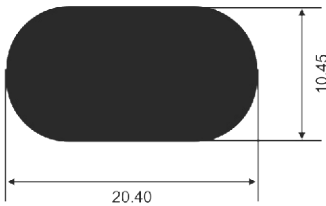

TB-4

(Kg. / 12 Ft. = 1.780)

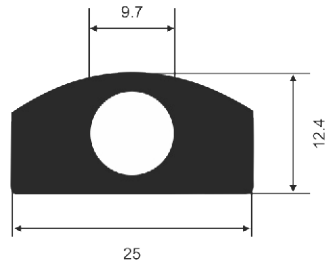

TB-5

(Kg. / 12 Ft. = 2.460)

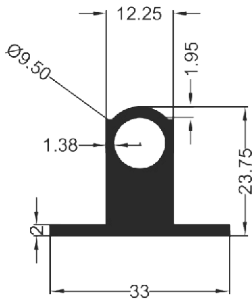

TB-6

(Kg. / 12 Ft. = 1.670)

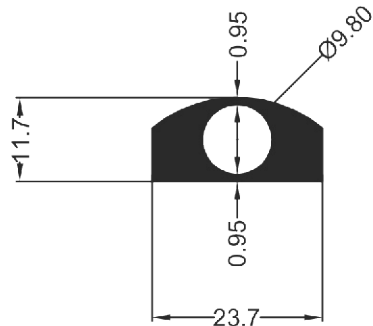

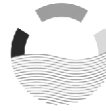

TB-7 (Kg. / 12 Ft. = 1.800)

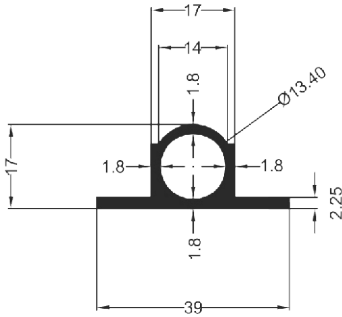

TB-8 (Kg. / 12 Ft. = 1.700)

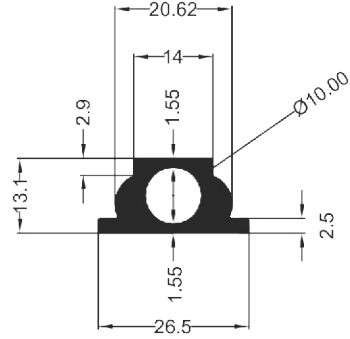

TB-9 (Kg. / 12 Ft. = 2.160)

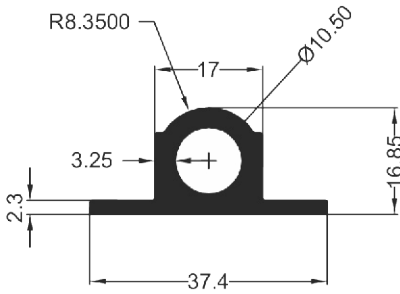

TB-10 (Kg. / 12 Ft. = 1.700)

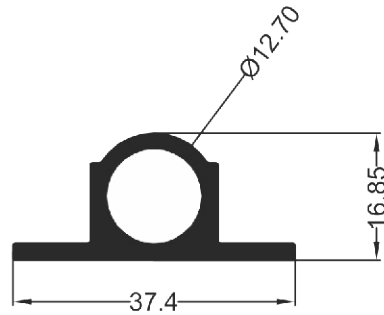

TB-11 (Kg. / 12 Ft. = 1.800)

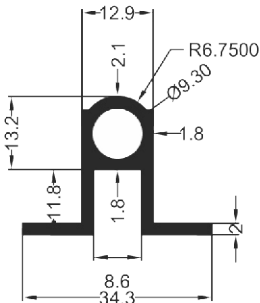

TB-12 (Kg. / 12 Ft. = 1.600)

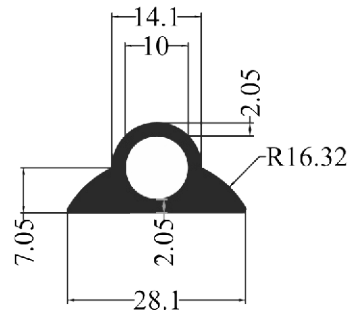



TB-13 (Kg. / 12 Ft. = 1.850)

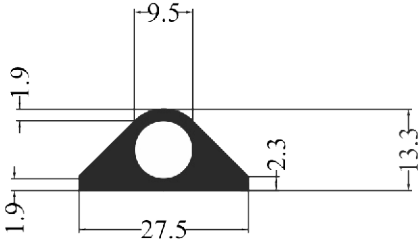

TB-14 (Kg. / 12 Ft. = 2.700)

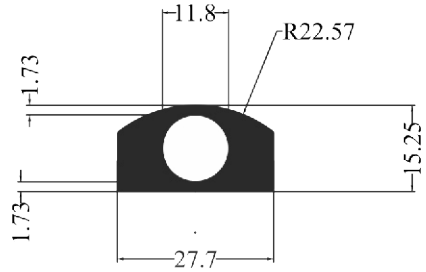

TB-15 (Kg. / 12 Ft. = 1.250)

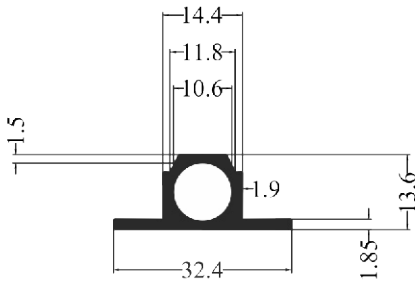

TB-16 (Kg. / 12 Ft. = 1.860)

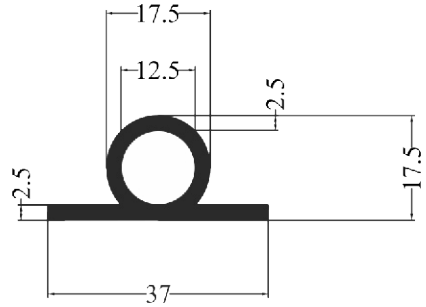

TB-17 (Kg. / 12 Ft. = 1.380)

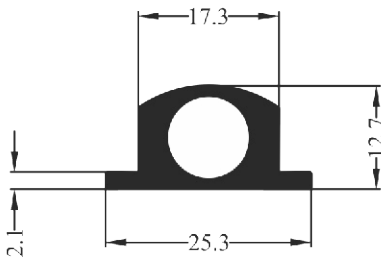

TB-18 (Kg. / 12 Ft. = 1.800)

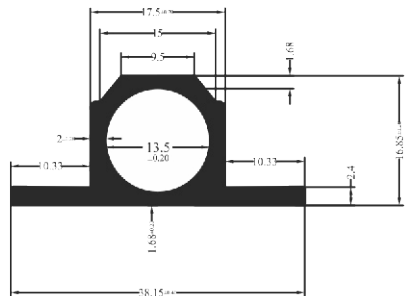

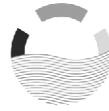

Oceanic
Aluminium Industries



RB-1 (Kg. / 12 Ft. = 9.500)

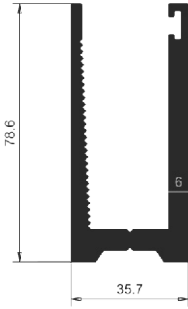

RB-2 (Kg. / 12 Ft. = 18.150)

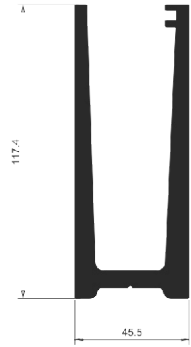

RB-3 (Kg. / 12 Ft. = 6.400)

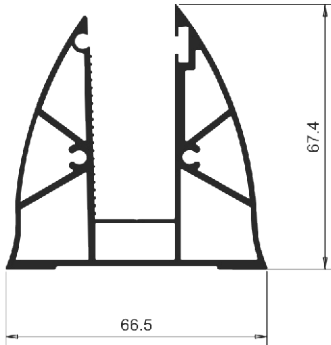

RB-4 (Kg. / 12 Ft. = 26.150)

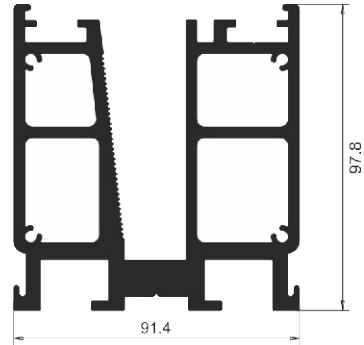

RB-5 (Kg. / 12 Ft. = 6.600)

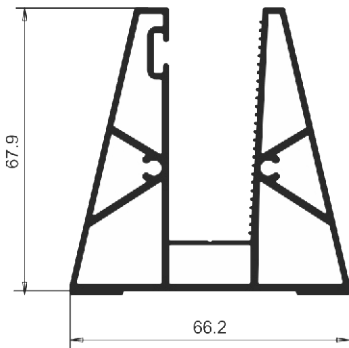

RB-6 (Kg. / 12 Ft. = 12.500)

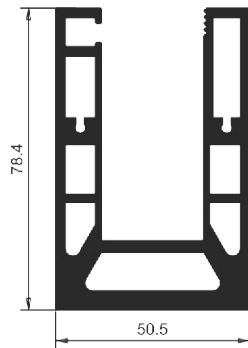



RB-7 (Kg. / 12 Ft. = 7.600)

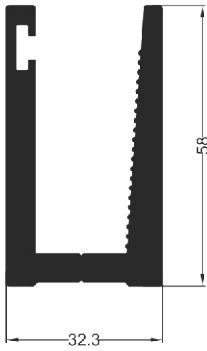

RB-8 (Kg. / 12 Ft. = 4.950)

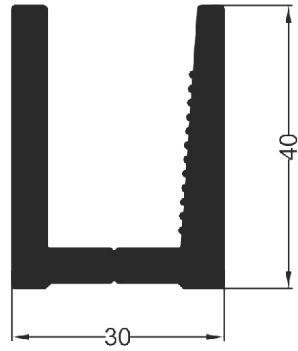

RB-9 (Kg. / 12 Ft. = 29.170)

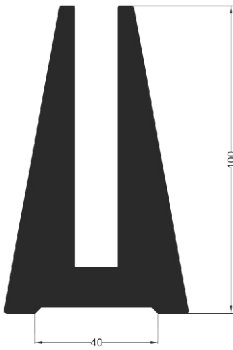

RB-10 (Kg. / 12 Ft. = 21.40)

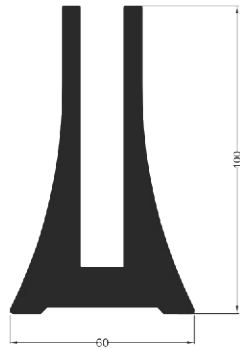

RB-11 (Kg. / 12 Ft. = 13.340)

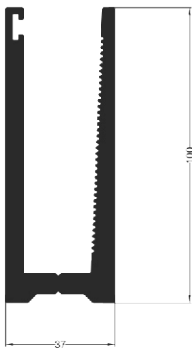

RB-12 (Kg. / 12 Ft. = 12.00)

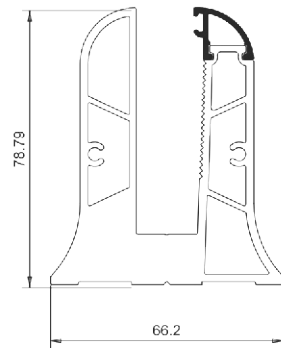



RB-13 (Kg. / 12 Ft. = 8.400)

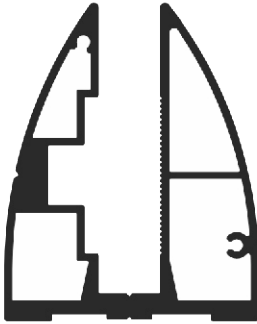

RB-14 (Kg. / 12 Ft. = 10.00)

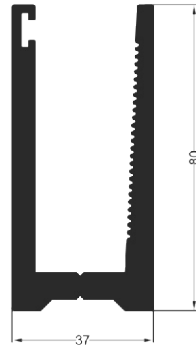

RB-15 (Kg. / 12 Ft. = 2.850)

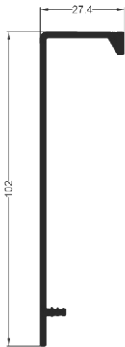

RT-1 (Kg. / 12 Ft. = 4.100)

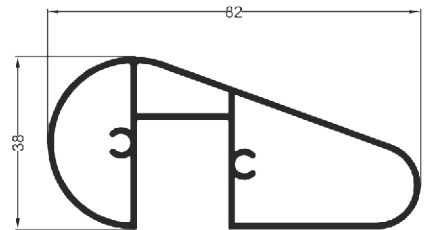

RT-2 (Kg. / 12 Ft. = 5.730)

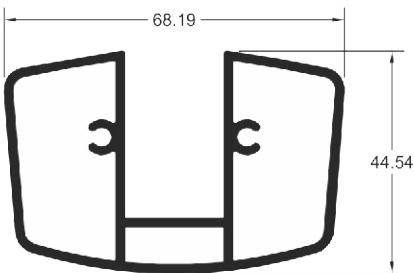

RT-3 (Kg. / 12 Ft. = 3.890)

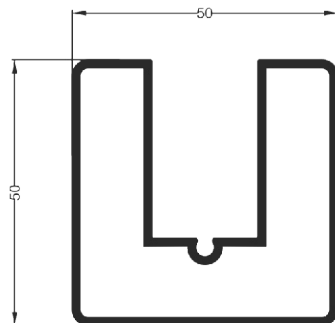



RT-4 (Kg. / 12 Ft. = 1.920)

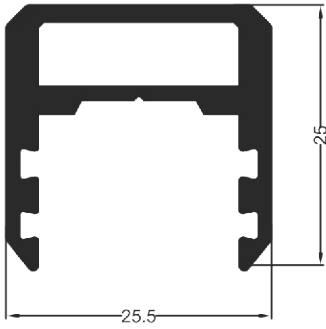

RT-5 (Kg. / 12 Ft. = 2.000)

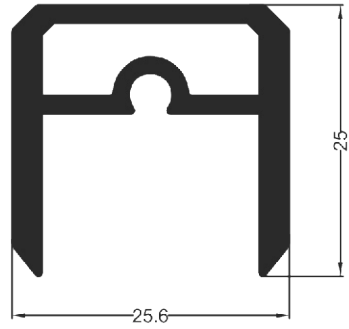

RT-6 (Kg. / 12 Ft. = 3.750)

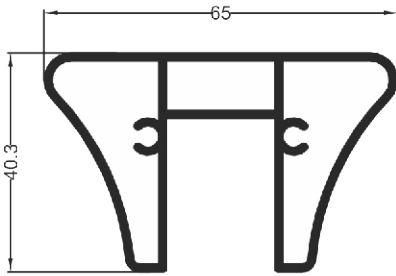

RT-7 (Kg. / 12 Ft. = 3.000)

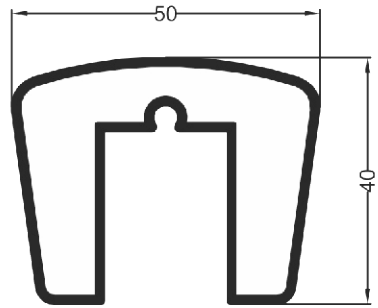

RT-8 (Kg. / 12 Ft. = 3.560)

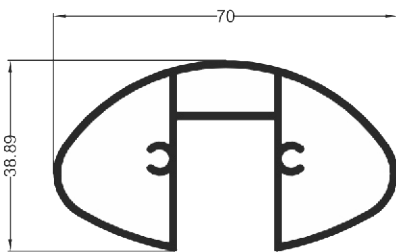

RT-9 (Kg. / 12 Ft. = 3.850)

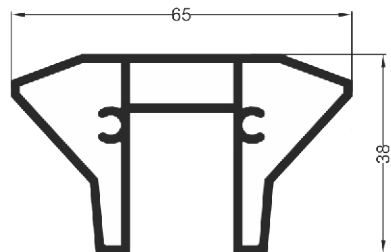



RT-10 (Kg. / 12 Ft. = 3.750)

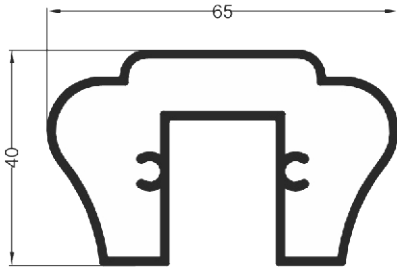

RT-11 (Kg. / 12 Ft. = 3.900)

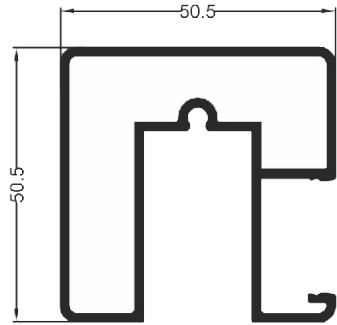

RT-12 (Kg. / 12 Ft. = 3.700)

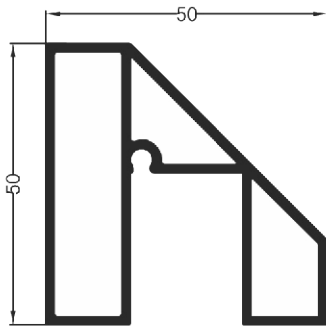

RT-13 (Kg. / 12 Ft. = 3.500)

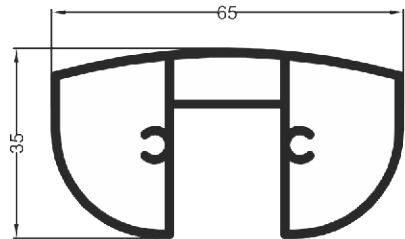

RT-14 (Kg. / 12 Ft. = 2.550)

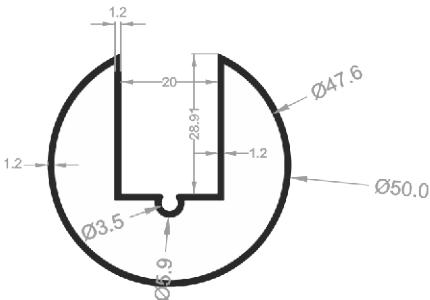

RC-1 (Kg. / 12 Ft. = 9.100)

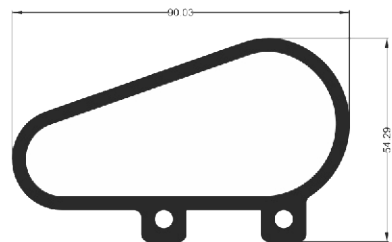

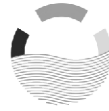

RC-2 (Kg. / 12 Ft. = 7.600)

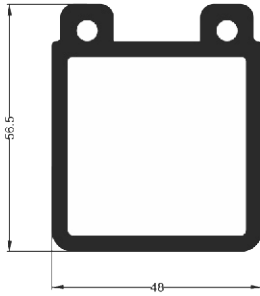

RC-3 (Kg. / 12 Ft. = 8.750)

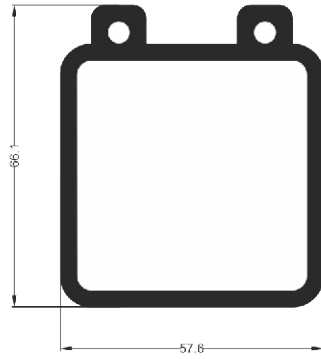

RC-4 (Kg. / 12 Ft. = 7.680)

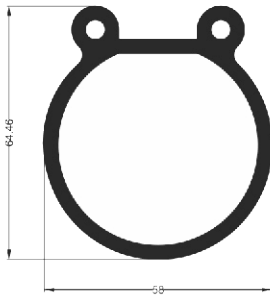

RC-5 (Kg. / 12 Ft. = 6.950)

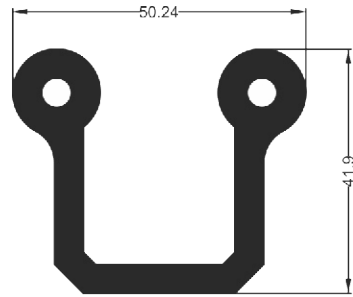

RC-6 (Kg. / 12 Ft. = 9.250)

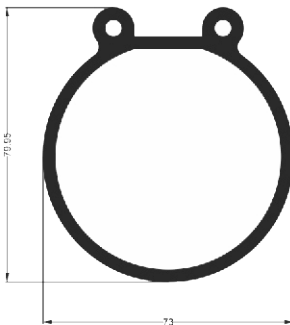

RC-7 (Kg. / 12 Ft. = 9.180)

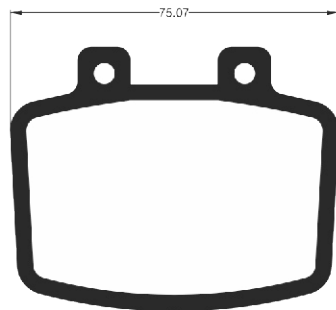



RC-8 (Kg. / 12 Ft. = 6.930)

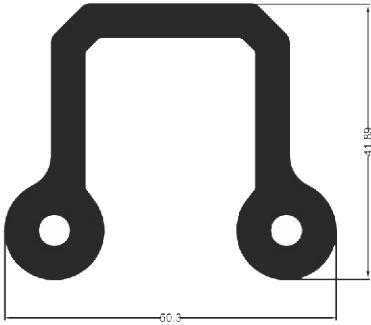

RC-9 (Kg. / 12 Ft. = 11.680)

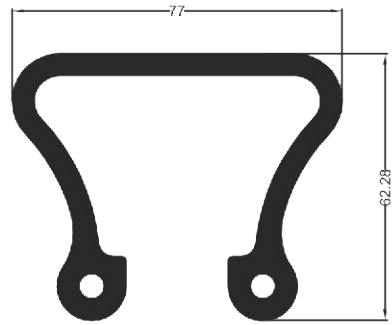

RC-10 (Kg. / 12 Ft. = 12.390)

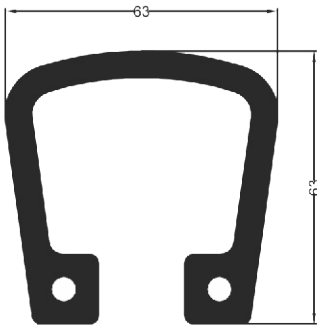

RC-11 (Kg. / 12 Ft. = 13.450)

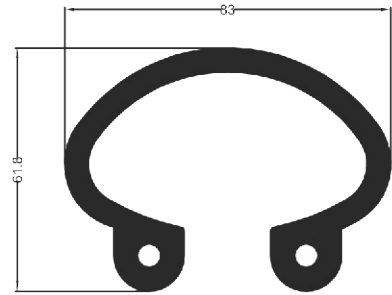

RB-16 (Kg. / 12 Ft. = 17.670)

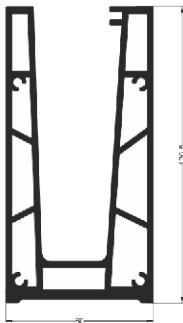

RB-17 (Kg. / 12 Ft. = 21.040)

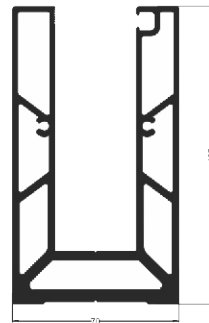

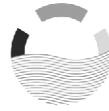

Oceanic
Aluminium Industries



WP-1

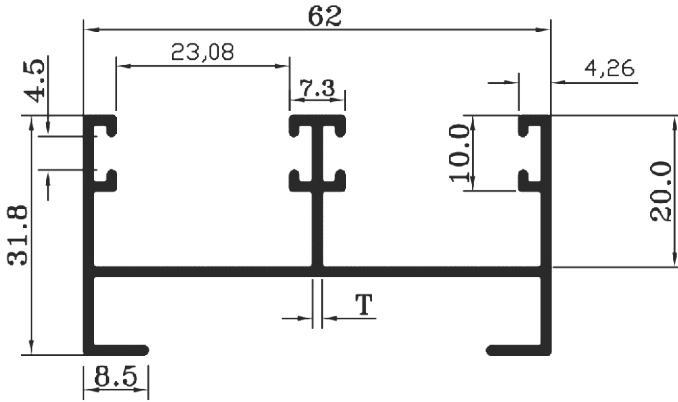

Sec. No.	A	B	T	Wt. (Kg./Mtr.)	Wt. (Kg./12')
WP-1 - L	62.00	31.80	0.85	0.450	1.650 - 1.750
WP-1 - M	62.00	31.80	1.00	0.591	1.900 - 2.000
WP-1 - H	62.00	31.80	1.20	0.655	2.400 - 2.500

WP-2

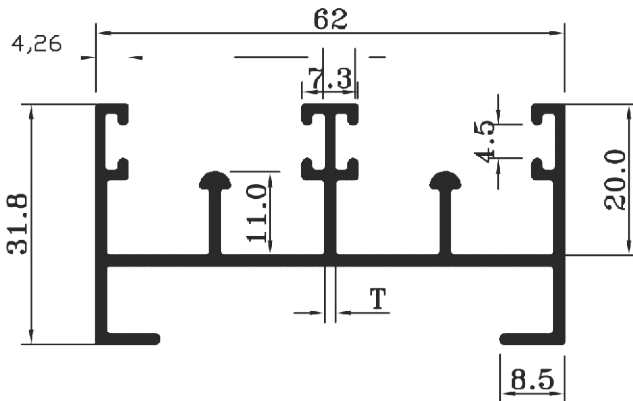

Sec. No.	A	B	T	Wt. (Kg./Mtr.)	Wt. (Kg./12')
WP-2 - L	62.00	31.80	0.85	0.532	1.950 - 2.050
WP-2 - M	62.00	31.80	1.00	0.601	2.200 - 2.300
WP-2 - H	62.00	31.80	1.20	0.737	2.700 - 2.800

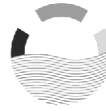

WP-3

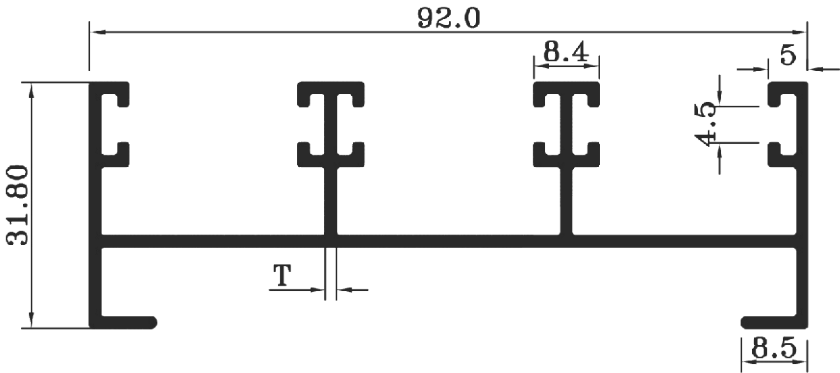

Sec. No.	A	B	T	Wt. (Kg./Mtr.)	Wt. (Kg./12')
WP-3 - L	92.00	31.80	0.85	0.601	2.200 - 2.300
WP-3 - M	92.00	31.80	1.00	0.710	2.600 - 2.700
WP-3 - H	92.00	31.80	1.20	0.874	3.200 - 3.300

WP-4

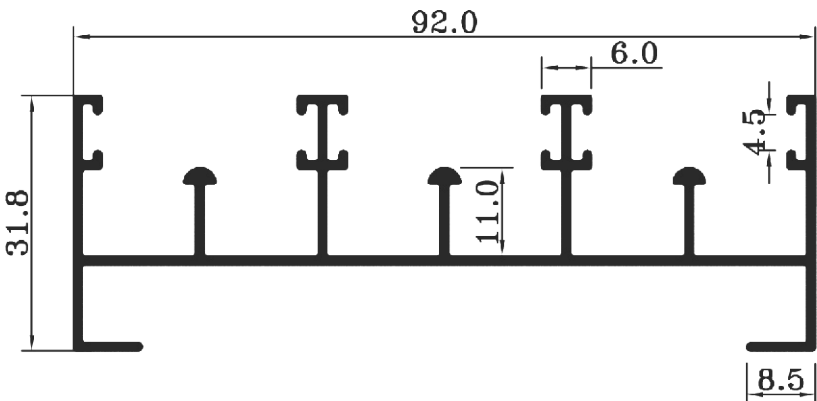

Sec. No.	A	B	T	Wt. (Kg./Mtr.)	Wt. (Kg./12')
WP-4 - L	92.00	31.80	0.85	0.724	2.650 - 2.750
WP-4 - M	92.00	31.80	1.00	0.819	3.000 - 3.100
WP-4 - H	92.00	31.80	1.20	1.024	3.750 - 3.850



WP-5

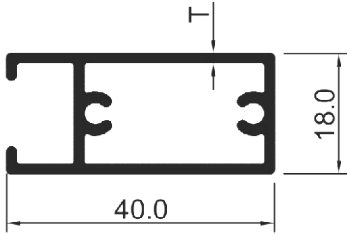

Sec. No.	T	Wt. (Kg./Mtr.)	Wt. (Kg./12')
WP-5 - L	0.85	0.300	1.100 - 1.200
WP-5 - M	1.00	0.355	1.300 - 1.400
WP-5 - H	1.20	0.437	1.700 - 1.800

WP-6

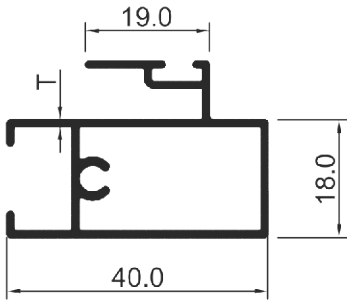

Sec. No.	T	Wt. (Kg./Mtr.)	Wt. (Kg./12')
WP-6 - L	0.85	0.355	1.300 - 1.400
WP-6 - M	1.00	0.423	1.550 - 1.650
WP-6 - H	1.20	0.505	1.850 - 1.950

WP-7

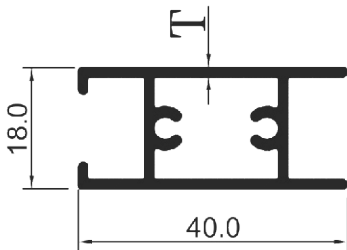

Sec. No.	T	Wt. (Kg./Mtr.)	Wt. (Kg./12')
WP-7 - L	0.85	0.314	1.150 - 1.250
WP-7 - M	1.00	0.355	1.300 - 1.400
WP-7 - H	1.20	0.430	1.590 - 1.690

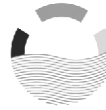

WP-8

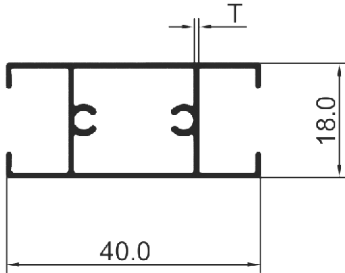

Sec. No.	T	Wt. (Kg./Mtr.)	Wt. (Kg./12')
WP-8 - L	0.85	0.300	1.100 - 1.200
WP-8 - M	1.00	0.355	1.300 - 1.400
WP-8 - H	1.20	0.437	1.700 - 1.800

WP-9

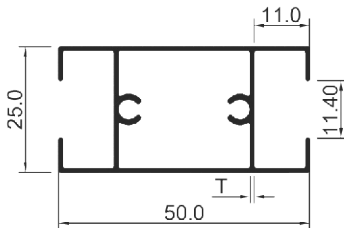

Sec. No.	T	Wt. (Kg./Mtr.)	Wt. (Kg./12')
WP-9 - L	0.85	0.437	1.600 - 1.700
WP-9 - M	1.00	0.382	1.850 - 1.950
WP-9 - H	1.20	0.600	2.200 - 2.300

WP-10

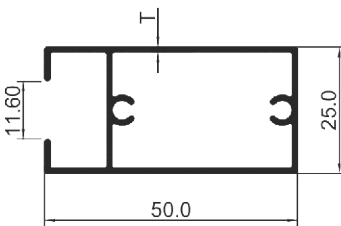

Sec. No.	T	Wt. (Kg./Mtr.)	Wt. (Kg./12')
WP-10 - L	0.85	0.409	1.500 - 1.600
WP-10 - M	1.00	0.478	1.750 - 1.850
WP-10 - H	1.20	0.573	2.100 - 2.200

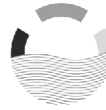

WP-14

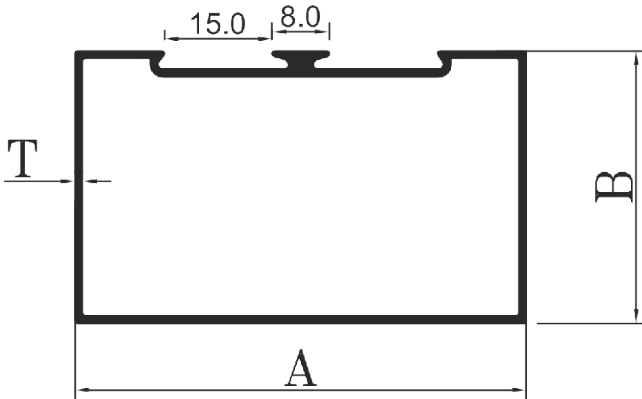

Sec. No.	A	B	T	Wt. (Kg./Mtr.)	Wt. (Kg./12')
WP-14 - L	63.00	38.00	0.85	0.519	1.900 - 2.000
WP-14 - M	63.00	38.00	1.00	0.573	2.100 - 2.200
WP-14 - H	63.00	38.00	1.20	0.683	2.500 - 2.600

WP-15

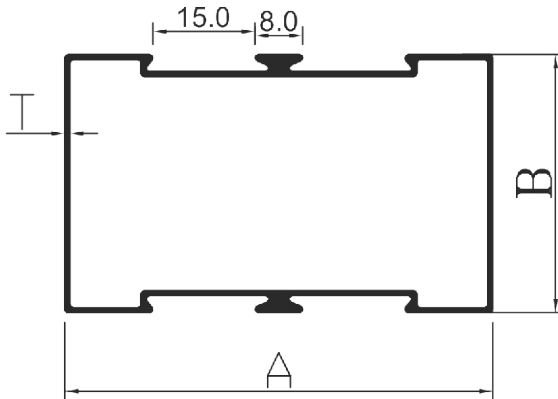

Sec. No.	A	B	T	Wt. (Kg./Mtr.)	Wt. (Kg./12')
WP-15 - L	63.00	38.00	0.85	0.546	2.000 - 2.200
WP-15 - M	63.00	38.00	1.00	0.546	2.300 - 2.400
WP-15 - H	63.00	38.00	1.20	0.737	2.700 - 2.800



WP-16 (Kg. / 12 Ft. = 2.400)

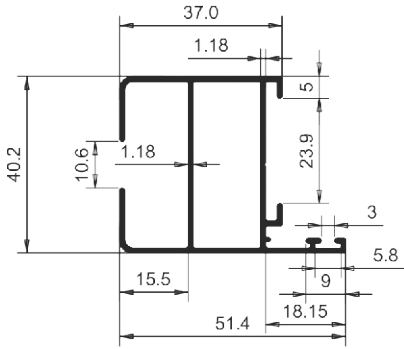

WP-17 (Kg. / 12 Ft. = 2.800)

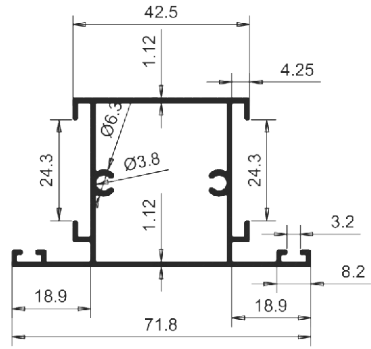

WP-18 (Kg. / 12 Ft. = 2.500 / 2.800)

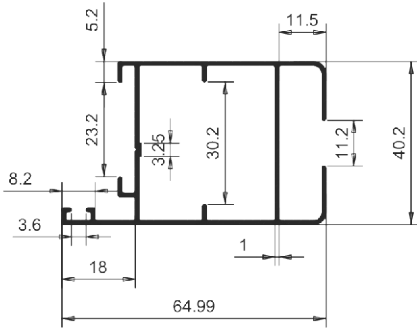

WP-19 (Kg. / 12 Ft. = 3.400)

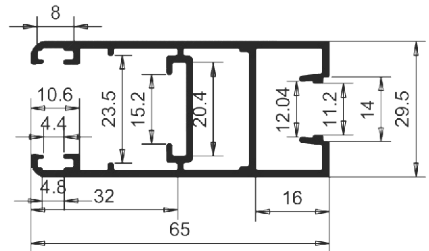

WP-20 (Kg. / 12 Ft. = 2.650 / 2.200)

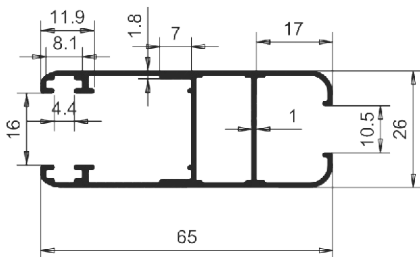

WP-21 (Kg. / 12 Ft. = 1.07)

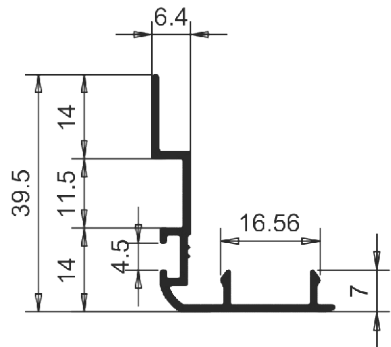

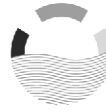

WP-22 (Kg. / 12 Ft. = $\frac{1.880}{1.650}$)

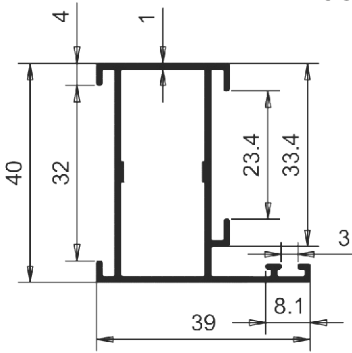

WP-23 (Kg. / 12 Ft. = 1.250)

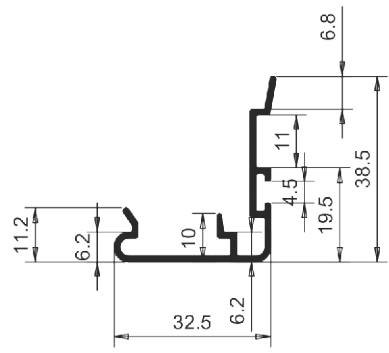

WP-24 (Kg. / 12 Ft. = $\frac{3.600}{4.100}$)

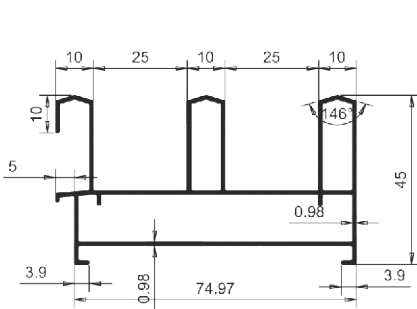

WP-25 (Kg. / 12 Ft. = 2.400)

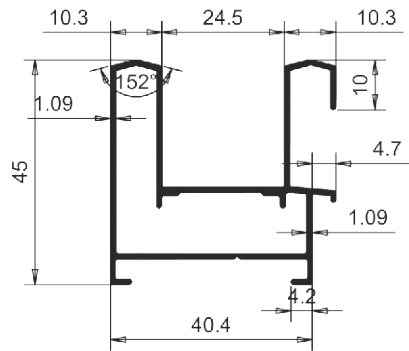

WP-26 (Kg. / 12 Ft. = 0.780)

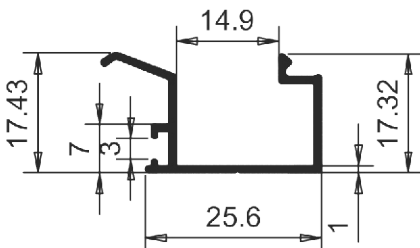

WP-27 (Kg. / 12 Ft. = 3.000)

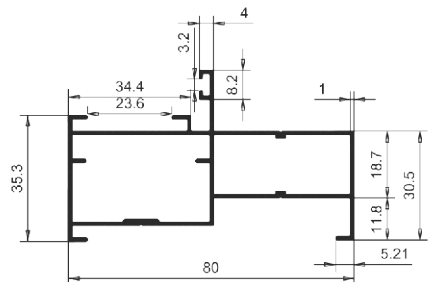



WP-31

(Kg. / 12 Ft. = 3.800)

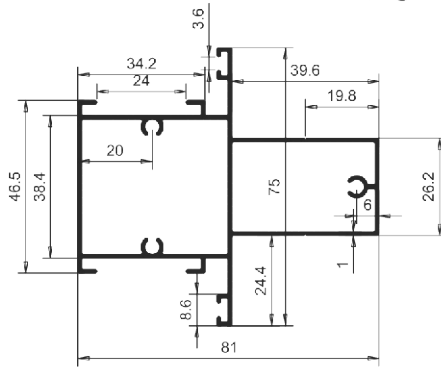

WP-32

(Kg. / 12 Ft. = 4.900)

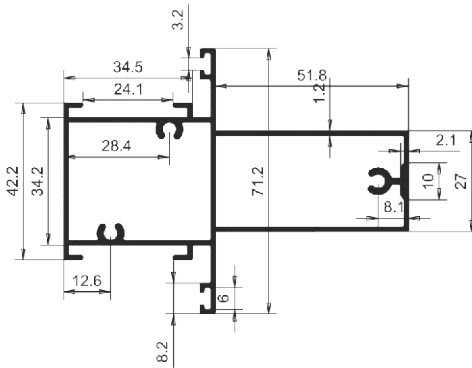

WP-33

(Kg. / 12 Ft. = 3.400)

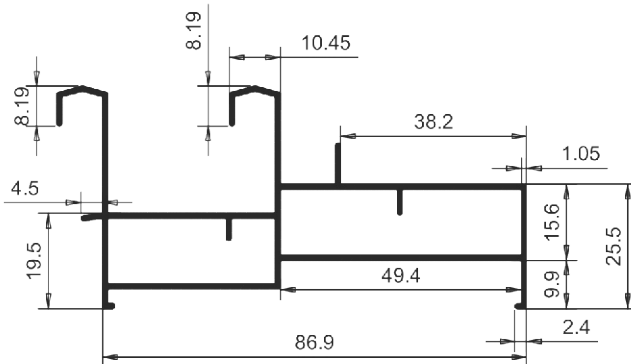

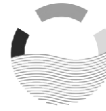

WP-35 (Kg. / 12 Ft. = 3.250)

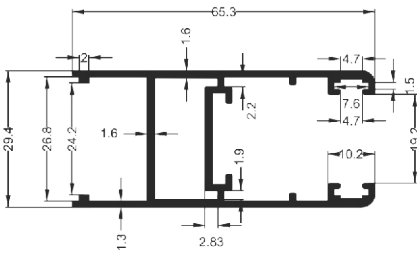

WP-36 (Kg. / 12 Ft. = $\frac{4.200}{3.500}$)

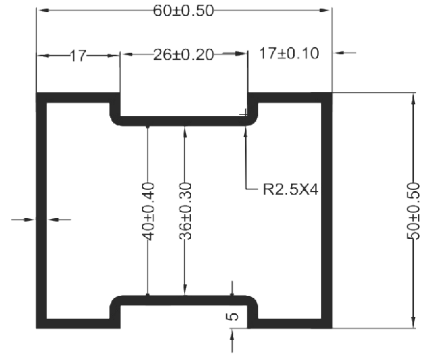

WP-37 (Kg. / 12 Ft. = 3.250)

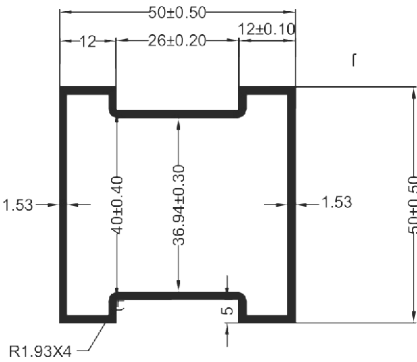

WP-38 (Kg. / 12 Ft. = 2.900)

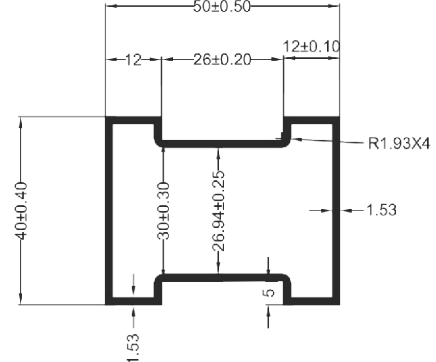

WP-39 (Kg. / 12 Ft. = 4.200)

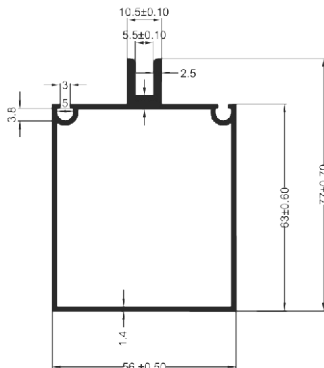

WP-40 (Kg. / 12 Ft. = $\frac{2.200}{2.400}$)

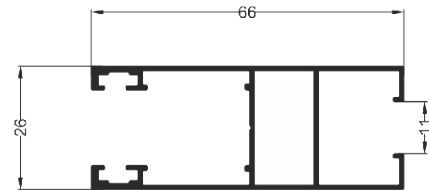



WP-41

(Kg. / 12 Ft. = 4.250)

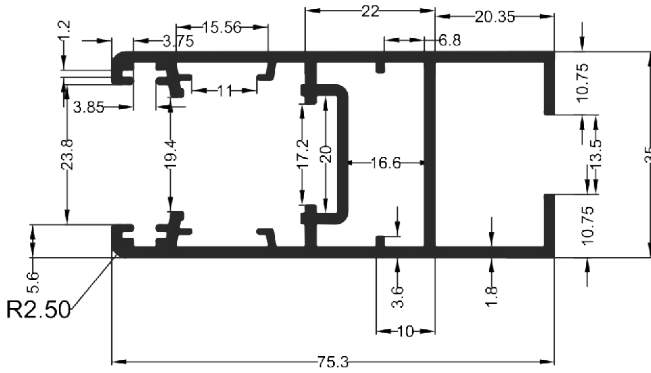

WP-42

(Kg. / 12 Ft. = 7.400)

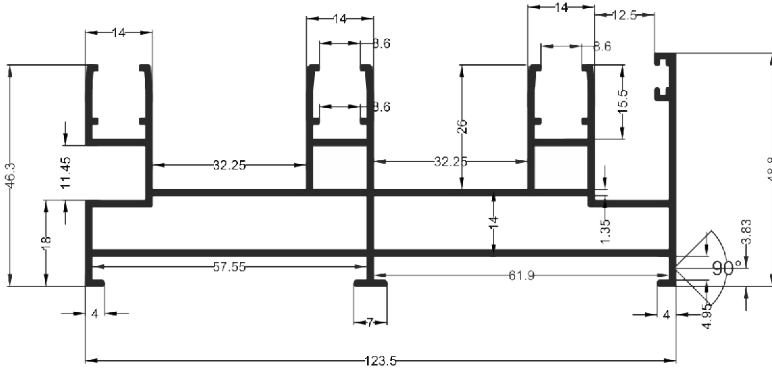

WP-43

(Kg. / 12 Ft. = 1.500)

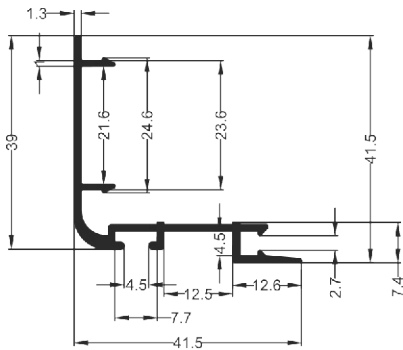

WP-44

(Kg. / 12 Ft. = 1.300)

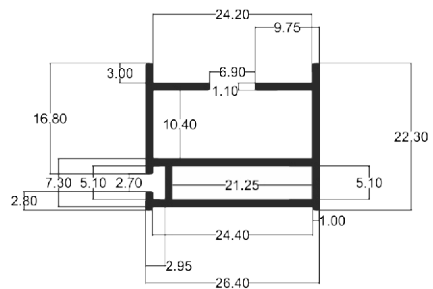

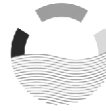

WP-45 (Kg. / 12 Ft. = 2.01)

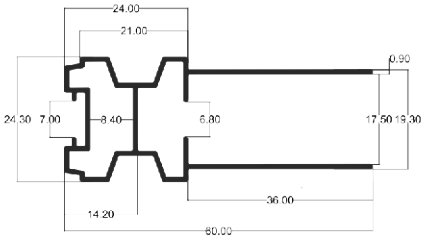

WP-46 (Kg. / 12 Ft. = 1.900)

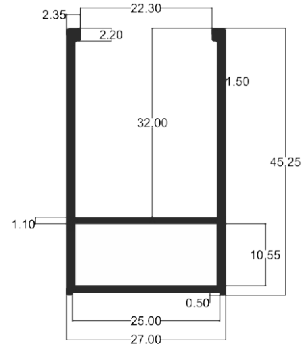

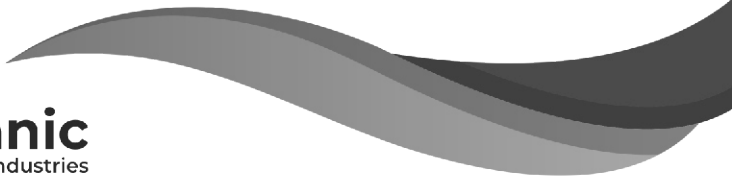





Oceanic

Aluminium Industries

Strength in Aluminium
Trust in Quality

Kush Vekaria

 +91 99137 67167

Raj Rabadia

 +91 81283 10066

Harsh Vekaria

 +91 98251 32164